

WELCOME

Welcome to Navy Gateway Inns & Suites

Thank you for Choosing NGIS, we're so glad to have you as our guest!

Our MISSION

Provide quality, affordable lodging and hospitality services, which contribute to mission accomplishment and quality of life for a mobile Defense community.

Our VISION

Navy Gateway Inns & Suites is **YOUR** preferred lodging choice.

Our BRAND PROMISE

Creating comfortable guest services for those we serve: Today and Tomorrow.



GUEST SATISFACTION

Please take a moment and complete a guest comment card located at the front desk, or the electronic survey sent after check out.

Your feedback is appreciated — Thank You

LOCAL BASE INFORMATION

Commander Fleet Activities Sasebo Japan

Commander, Fleet Activities Sasebo (CFAS) co-exists with the host nation's Japanese Maritime Self Defense Force (JMSDF) and is located on Japan's southernmost island of Kyushu. Sasebo City is roughly a 90 minute drive from Fukuoka City which is Kyushu's largest city. The base operator's phone number is 011-81-956-50-6111.

Fleet Activities Sasebo continues to support ships of the U.S. Seventh Fleet. Service Force ships as well as mine sweeps make Sasebo their homeport. U.S. Fleet Activities Sasebo provides logistic support to the expanded Seventh Fleet.

Welcome to Navy Gateway Inns & Suites, Commander Fleet Activities Sasebo Japan. It is our pleasure to welcome you as our guest and we wish you a pleasant stay.

Our staff is committed to providing the highest level of customer service and we pledge to do our personal best to make your stay an enjoyable one.

Front Desk Associates are available 24 hours a day, 7 days a week at DSN (315) 252-3794 to provide additional help or information during your stay.

The Guest Services Directory is provided to familiarize you with the services and amenities we offer at NGIS. If you have any concerns, comments, or suggestions feel free to contact the front desk.

We look forward to seeing you again!

Sincerely,

Shiella Angel S. Bellacera

General Manager

Child Development Center
DSN 252-2985 M-F 0600-1800

Fleet Fitness Complex
DSN 252-3588

Commissary
DSN 252-3675 M-F 1000-1900
SAT-SUN 1000-1800

Fleet & Family Support Center
DSN 252-3372 M-F 0800-1630

Outdoor Adventure Rentals
DSN 252-3500

Youth Sports
DSN 252-8963

Paws & Claws (Pet Kennel & Clinic)
DSN 252-2905 M-F 1100-1600
Sat & Sun 1100-1400

Tours & Travel
DSN 252-3433/2916 M-S 1000-1600

Navy Exchange
DSN 252-3510 M-S 0900-2000
SUN 1000-1900

Base Security
DSN 252-3446 M-Sun 24hrs

Pass and ID Office
DSN 252-6959 M,T,TH,F 0730-1600

COMMAND DUTY OFFICER
81-080-1046-1695

EMERGENCY CALL 911

GUEST SERVICES

NAVY GATEWAY INNS & SUITES

We are committed to providing our guests with comfortable and safe lodging accommodations. We offer the following information for your awareness and convenience to ensure your stay is enjoyable, and that we meet your expectations!

Check-In. Guests may check in at any time if a room is available. Check-in time is 3:00 p.m.

Check Out. 11:00 a.m. Early check-in and late checkout may be granted whenever possible.

Community Activities and MWR Dining. For more information, please visit the MWR website at <https://www.navymwr.org/links> or scan this QR code:



Forget Something? Complimentary items may be picked up at the front desk: razors, shaving cream, toothbrush, and toothpaste.

Heating and Air-Conditioning System. Some thermostat settings are centrally operated by the Public Works Department with indoor temperatures between 66 and 78 degrees. Individual room thermostats should be set no higher than 78 degrees per DoD and Navy regulations.

Housekeeping Services. Housekeeping services are provided 7 days a week. Linens are changed upon request or every 7th day. Amenities and bed/bath linens are available upon request.

Maintenance. Please let us know if your guest room requires maintenance service. Our Front Desk will provide assistance. Dial Front Desk Number 252-3794 from your guest room phone.

Payment Options. American Express, Discover, MasterCard, Visa, check/debit card, and traveler's checks. Personal checks are not accepted. NGIS no longer accepts cash. A form of payment is required at check-in. All guests must provide a valid credit card and government identification card at check-in.

Personal Mail. NGIS cannot receive personal mail. Please contact the Post Office or your local command if you have mail needs.

STAY CONNECTED

WIFI Instructions

Internet Access

1. Access your device setting for wireless adapter network setup.
2. Find "Navy_Gateway_Inns"
3. Select Security Encryption WPA2, and enter password: NavyGatewayInns (Note: Password case sensitive)
4. Open your browser. Follow the prompts, and accept the Terms and Condition.

For further assistance please contact the Front Desk or Americable, 241-2288 option 2, and leave your building and room number. They will call back.

Telephone Dialing

1. Emergency 911
2. DSN Operator: Dial 0
3. NGIS Front Desk:
DSN: 252- 3794 and 252- 3413
Cell Phone: 0956 50 plus the last 4 digit of DSN number.
Calling from State side Number: +81 956 50 plus the last 4 digit of DSN number.
4. Room to Room: Please contact Front Desk for dialing instruction.
5. Local calls, toll free and calls to Continental US are not available in guest rooms.

DISASTER PROCEDURES

Earthquakes

Although few and far between, earthquakes are an actuality in Japan. If an earthquake should occur, keep the following procedures in mind:

1. If indoors, stand under a doorway or get under a sturdy piece of furniture for shelter. Stay away from the windows.
2. If outdoors, stay in the open, away from buildings and overhead debris.
3. DO NOT use the elevators, even if they are working. There may be aftershocks.

Typhoon conditions

Typhoons frequently threaten Sasebo during the summer months (1 June – 30 November). Most buildings on the island were designed to withstand high winds, although occasionally slight damage occurs, usually caused by windblown debris. The single most important safety factor is to **REMAIN INDOORS, especially when mandatory**. The storm will likely pass in a day or two.

Typhoon Conditions:

As the storms approach the Kyushu Island, the CFAS prepare by setting the following **Tropical Cyclone Conditions of Readiness (TCCOR)**.

TCCOR - 4: Destructive winds of 50 knots or greater are possible within 72 hours.

TCCOR - 3: Destructive winds of 50 knots or greater are possible within 48 hours.

TCCOR - 2: Destructive winds of 50 knots or greater are possible within 24 hours.

TCCOR - 1: Destructive winds of 50 knots or greater are possible within 12 hours.

TCCOR - 1C (Caution): Sustained winds of 34 to 49 knots (39 to 56 MPH) with frequent gusts of 50 to 59 knots (58 to 68 MPH) are occurring.

TCCOR - 1E (Emergency): Sustained winds of 50 knots (58 MPH) or greater with frequent gusts of 60 knots (69 MPH) or greater are occurring.

TCCOR - 1R (Recovery): Sustained winds fall below 50 knots and gusts of 60 knots or greater are no longer occurring.

TCCOR - SW (Storm Watch): At a minimum sustained damaging force winds of 34 to 49 knots with significant higher gusts of up to 59 knots.

TCCOR - AC (ALL Clear): The meteorological system has passed and the threat of severe weather is over and it is safe to go outdoors.

Evacuation route is located on the back of your door.

DURING EMERGENCY ALWAYS CALL 911

In case of Fire

It is necessary that all personnel conscientiously exercise constant vigilance in matter of fire prevention. In case of fire, the following steps must be taken:

If a Fire begins in your Room:

Leave your room and close the door behind you to keep smoke and flames out of the corridor. Sound the alarm. Leave the building by the nearest exit.

If you hear the Alarm:

1. Leave the building through the nearest safe exit.

2. If there is evidence of smoke in the room, roll out of bed and crawl on the floor. – DO NOT STAND!

Smoke and deadly gasses rise.

3. If you can leave safely, take your room key with you and close the door behind you.

4. Go to the nearest safe exit.

TELEVISION CHANNEL LINEUP

Americable Channels

Free AFN TV

Ch. 7 AFN Pacific
Ch. 8 AFN Atlantic
Ch. 9 AFN News
Ch. 10 AFN Sports

Ch. 11 AFN Spectrum
Ch. 12 AFN Family
Ch. 13 AFN Movies
Ch. 13 AFN Sports 2

Ch. 16 Weather Channel
Ch. 18 NHK 3
Ch. 20 TBS 6
Ch. 22 Asahi 10
Ch. 24 Kanagawa

Free Local TV

Ch. 17 NHK 1
Ch. 19 NTV 4
Ch. 21 Fuji 8
Ch. 23 Tokyo 12
Ch. Commander Channel

Digital Basic

Ch. 107 AFN Pacific
Ch. 110 AFN Sports
Ch. 113 AFN Movies
Ch. 117 Commanders Channel
Ch. 122 Big 10 Network
Ch. 125 FXX
Ch. 128 Animal Planet
Ch. 131 Food Network
Ch. 134 FX Network
Ch. 137 Life Time Movie Network
Ch. 141 Comedy Central
Ch. 144 HLN
Ch. 147 MTV
Ch. 150 BET
Ch. 153 EWTN
Ch. 156 Freeform
Ch. 159 Cartoon Network.

Ch. 108 AFN Atlantic
Ch. 111 AFN Spectrum
Ch. 114 AFN Sports 2
Ch. 120 FOX Sports 1
Ch. 123 USA
Ch. 126 TV Land
Ch. 129 Travel Channel
Ch. 132 HGTV
Ch. 135 Fox Network Japan
Ch. 138 FXM
Ch. 142 CNNj
Ch. 145 History
Ch. 148 MTV 2
Ch. 151 Univision
Ch. 154 PBS
Ch. 157 Nickelodeon

Ch. 109 AFN News
Ch. 112 AFN Family
Ch. 116 Weather Channel
Ch. 121 FOX Sports 2
Ch. 124 SyFy
Ch. 127 Discovery
Ch. 130 TLC
Ch. 133 A & E
Ch. 136 Lifetime
Ch. 140 Paramount
Ch. 143 Fox News
Ch. 146 CMT
Ch. 149 VH1
Ch. 152 Galavision
Ch. 155 PBS
Ch. 158 Nick Jr.

Stingray Digital Audio Channels

Ch. 901 Pop Classics
Ch. 905 Eclectic
Ch. 909 Jazz Masters
Ch. 913 Gospel
Ch. 917 Hot Country
Ch. 921 Flashback 70's
Ch. 925 Rock
Ch. 929 Adult Alternative
Ch. 933 Groove
Ch. 937 Jammin
Ch. 941 Éxitos del Momento
Ch. 945 Romance Latino
Ch. 949 Kids' Stuff

Ch. 902 Classic Masters
Ch. 906 The Spa Lounge
Ch. 910 Jazz Now
Ch. 914 Christian Pop & Rock
Ch. 918 Alt Country/Americana
Ch. 922 Everything 80's
Ch. 926 Classic Rock
Ch. 930 Alt Rock Classics
Ch. 934 Maximum Party
Ch. 938 Soul Storm
Ch. 942 Ritmos Latinos
Ch. 946 Retro Latino
Ch. 950 Holiday Hits

Ch. 903 Chamber Music
Ch. 907 Easy Listening
Ch. 911 Hip Hop
Ch. 915 No Fences
Ch. 919 Bluegrass
Ch. 923 Nothin' but 90's
Ch. 927 Heavy Metal
Ch. 931 Hit List
Ch. 935 Hip-Hop/R&B
Ch. 939 Classic R&B
Ch. 943 Éxitos Tropicales
Ch. 947 Y2K

Ch. 904 Broadway
Ch. 908 Smooth Jazz
Ch. 912 Swinging Standards
Ch. 916 Country Classics
Ch. 920 Jukebox Oldies
Ch. 924 Pop Adult
Ch. 928 Alternative
Ch. 932 Dance Clubbin'
Ch. 936 The Chill Lounge
Ch. 940 The Blues
Ch. 944 Rock en Espanol
Ch. 948 Folk Roots

ROOM EQUIPMENT INSTRUCTIONS

TV Remote Control Operation:

To turn on TV and Cable Box

- Press System button on remote
- Press Cable button on remote
- *Then change channels and volume using those respective buttons*

Alarm Clock Instructions:

Timex Alarm Clock Radio

Setting the alarm:

- Press Alarm Set, then press ◀◀ or ▶▶
- Select a preset radio button (skip this step to wake to buzzer)
- Press Enter

To use MP3 line-in:

- Plug cord into any music device's headphone jack or line-out jack
- Press Aux button on top of clock radio to play your music

CFAS Schedule Heating and Cooling Season:

Heat On/Off:

NAVFAC will release schedule on when to turn on and off the heater once release, NGIS building manager will send a memo to the guest.

Air Conditioning On/Off:

NAVFAC will release schedule on when to turn on and off the heater once release, NGIS building manager will send a memo to the guest.

DINING OPTIONS FOR ON AND OFF BASE

Harbor View Club (HVC)

252-3965

Chops:

Breakfast:

Mon - Fri : 0630-0900

Sat: 0630-1000

Lunch:

Mon - Sat : 1100-1400

Dinner:

Mon - Sat : 1700-2100

Khaki Lounge:

Daily: 1100-2300

Popeye's • 252-2494

Mon - Sun: 1000-1900

Bayside Food Court • 252-3478

Sun - Thu : 0630-2000 • Fri & Sat : 0630-2100

Subway : 252-3476

Taco Bell : 252-2494

Baskin Robbins : 252-3476

Base Food Delivery Service (Main Base)

Delivery food menu is located at the back of this binder

Anthony's Pizza • 252-3476

Mon - Sun: 1500-2100

Harbor Cafe:

Mon - Fri : 0600-2100

Sat, Sun & Federal Holidays:

0700-2100

Mongolian BBQ:

Thurs : 1700-2100

Sunday Brunch:

Sun : 1000-1400

Galaxies • 252-2980

Wed & Thu : 1800-2400

Fri & Sat : 1800-0200

2nd Floor Lounge: opens 1630 p.m. daily

Brodie's (2nd Deck) • 252- 2977

Sun - Thu : 1100-2300

Fri & Sat : 1100-0100

McDonald's • 0956-26-0078

Mon - Sun : 0600-2400

Chili's • 252-2962

Mon - Sun : 1100-2100

Shogun Cafe (Galley) • 252-3873

Breakfast:

Mon - Fri: 0600 - 0800

Sat & Sun: 0700 - 0900

Lunch:

Mon - Fri: 1030 - 1230

Sat & Sun: 1030 - 1230

Dinner:

Mon - Fri: 0430 - 1800

Sat & Sun: 1630 - 1800

15 Minutes away from Commander Fleet Activities Sasebo you will find the area called 99 Island which offers a variety of food such as Ramen, Italian food, Burgers and Sea Foods. The Ginza area offers food, such as yakiniku, tonkatsu, ramen, Chinese, Indian, Italian, steak and hamburgers, coffee shops, and both local and international fast-food chains.

The Gobangai Mall which is 10 minutes away from Commander Fleet Activities Sasebo offers Sushi (Sushiro Restaurant), Ramen, fast food chains and coffee shops (Starbucks, Mr. Donuts, Godiva Chocolate Drinks).

OTHER INFORMATION AND SPECIAL NOTICES

Designated Smoking & Pet Waste Area

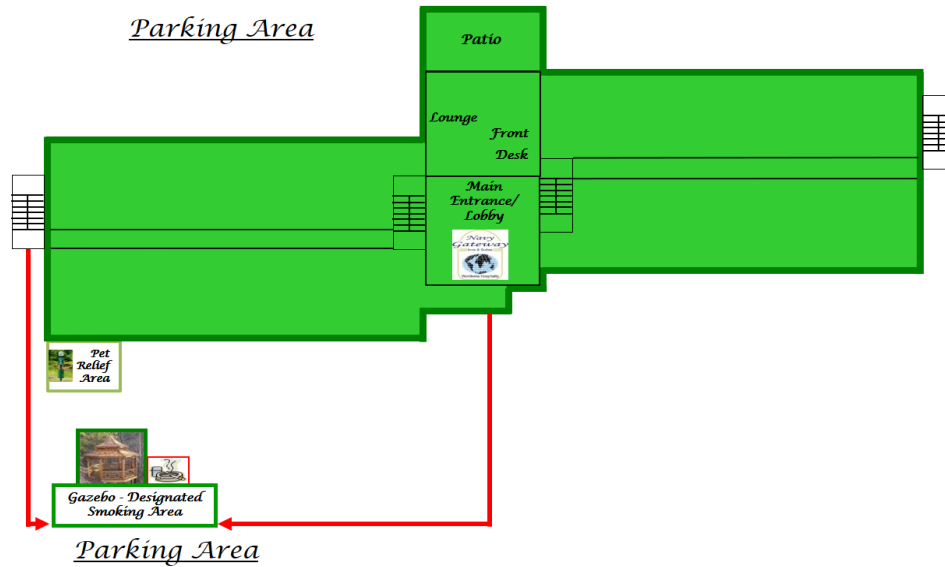

Smoking is prohibited in the guest rooms, lobby, hallways, and stairways.
Designated smoking area is located in the parking lot of south side of the building.

LINK TO MWR JAPAN:

<https://www.navymwrsasebo.com/directory-more/welcome-to-mwr-sasebo>